

FIXING INSTRUCTIONS

25mm FASCIA VENTILATOR – FV250

EAVES – Ventilation at the eaves where the roof pitch is less than 15° or the insulation follows the pitch of the roof.

ABUTMENTS – Ventilation at abutment of flat roof extension with an existing wall.

FLAT ROOFS – Eaves ventilation for flat roofs.

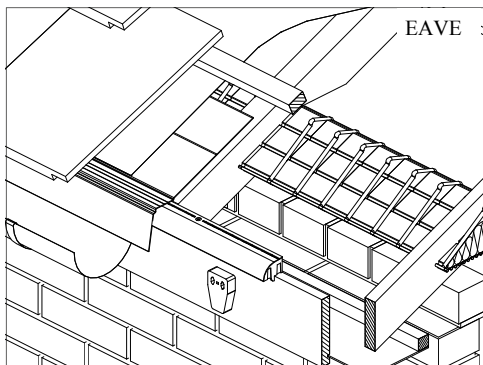

VENTILATING BELOW UNDERLAY

1. Fix the fascia board 30mm below the normal level (allowing for any counterbatten depth) to accommodate the height of the fascia vent.
2. Fix the fascia ventilator using aluminium alloy nails or other rustproof nails.
3. Slots in the top of the ventilator facilitate fixing of eaves fillers and tile clips into the top of the fascia board.
4. Lay leading edge of tilting fillet board onto top of ventilator to prevent ponding. A Glidevale Over Eaves Skirt is recommended which fulfils this function and replaces the underlay into the gutter.
5. Retain gutter brackets spacers for use when installing the gutter system to ensure correct positioning in relation to the tail of the eaves tiles.

VENTILATING ABOVE UNDERLAY

1. Fix the fascia board 27mm below the normal level (allowing for any counterbatten depth) to accommodate the height of the fascia vent.
2. Fit a Glidevale under fascia Eaves Skirt to the top of the fascia board and lay underlay in the normal way.
3. Nail fascia ventilator to top of fascia board and through the underlay with rust proof nails.
4. Slots in the top of the ventilator facilitate fixing of eaves fillers and tile clips into the top of the fascia board.
5. Retain gutter brackets spacers for use when installing the gutter system to ensure correct positioning in relation to the tail of the eaves tiles.
6. Continue to lay the counterbattens and battens in the normal way.

ABUTMENTS

The Ventilator should be installed the full width of the abutment.

1. Form an airspace with 25mm x 38mm battens, faced with 12mm WB plywood and fixed to the brickwork and roof timbers finishing 150mm above finished roof level.
2. For flat roofs complete the felting / asphaltting flush with the top edge of the plywood.
3. Fix the ventilator with aluminium alloy nails.
4. Fix a timber fillet at the top of the ventilator and complete normal lead flashing work dressing down a sufficient depth past the face of the ventilator to provide adequate weatherproofing.

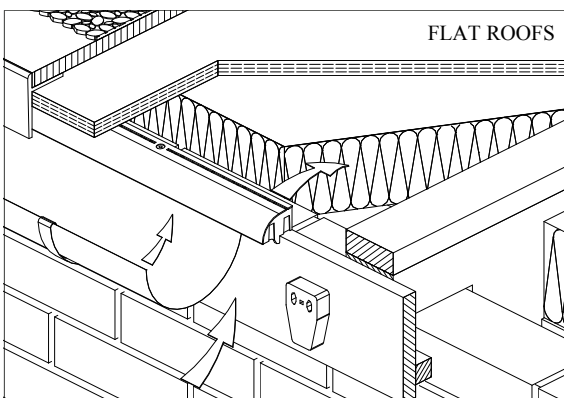
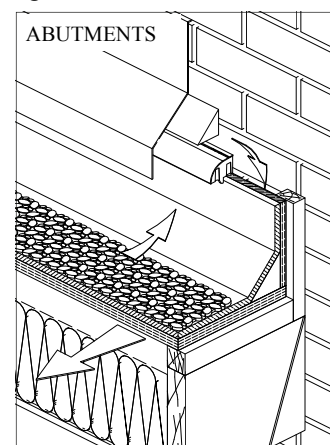

FLAT ROOF

The Ventilator should be installed the full length of the eaves.

1. Fix the fascia board 32mm lower than normal to allow for the fascia ventilator.
2. Fix the fascia ventilator using aluminium alloy nails.
3. Retain gutter bracket spacers for use when installing gutter system.
4. Note that the furring piece or joist should be level with the top of the ventilator to enable the roof decking to be fixed.

Company names and product descriptions are the Registered Trade Marks of the relevant manufacturer

FOR FURTHER INFORMATION ON ALL GLIDEVALE PRODUCTS PLEASE CONTACT:

.....

GLIDEVALE LIMITED

2 Brooklands Road, Sale, Cheshire, M33 3SS

Telephone: (+44) 0161 905 5700 Fax: (+44) 0161 905 2085 Web: www.glidevale.com Email: info@glidevale.com

BPD

A Member of the Building Product Design Group